

- **Compact size – 23mm (.906") diameter**
- **ABS case with acrylic window ultrasonically welded to case**
- **Wrench flats on socket for easy installation**
- **Available in 60-300 psi**
- **Direct Drive technology for excellent shock resistance**

The Ashcroft® MiniGauge™ is designed for those applications where space is a limiting factor. Taking into consideration the small size of the MiniGauge (23mm), the dial face

was designed for maximum readability. This product is offered in 1/8 NPT back connection with 15mm (9/16") wrench flats for easy installation.

The versatile Ashcroft MiniGauge surpasses the demands of durability in two important ways: first, by using direct-drive reading, the spiral tube transmits motion directly to the pointer – no gears or movement parts to wear out; and second, the case material is an ABS blend that is both enduring and attractive.

The Ashcroft MiniGauge is perfect for a multitude of applications where a 1 1/2" conventional size gauge is too large.



GAUGE SPECIFICATIONS

Type no.:	23DDG
Accuracy:	±5% of span
Size:	23mm (.906")
Case:	Black ABS blend
Ring:	None
Window:	Polycarbonate, ultrasonically welded to case
Dial:	Black figures on white background, aluminum
Pointer:	Brass, painted black
Bourdon tube:	Beryllium copper, spiral; soft soldered to socket
Movement:	None (direct-drive reading)
Socket:	Brass with 15mm (9/16") wrench flats
Connection:	1/8 NPT back

Range (psi)	Dial Arc	
	180°	235°
0/60	*	
0/100	*	
0/160		*
0/200		*
0/300		*

Repeatability:	Better than 1%
Operating temperature:	-40°F to 150°F
Packaging:	Bulk pack; individually sealed 2 mil polybags

Note: Consult factory for high cycle-life applications

GAUGE OPTIONS

Socket:	Throttle plugs; 10/32" threads; PT 1/8 (JIS) and R 1/8 (BSPT) threads
Dial:	Customized
Dampening:	Silicone-dampened coil for vibration applications

TO ORDER THIS TYPE 23DDG GAUGE:

Select: _____ **23** **DDG** **01B** **60#**

1. Gauge Size: 23mm (.906" or 29/32") _____

2. Case Type: Direct Drive Gauge _____

3. Connection Size/Location: 1/8 NPT back _____

4. Range: 0/60 psi _____

Dimensions

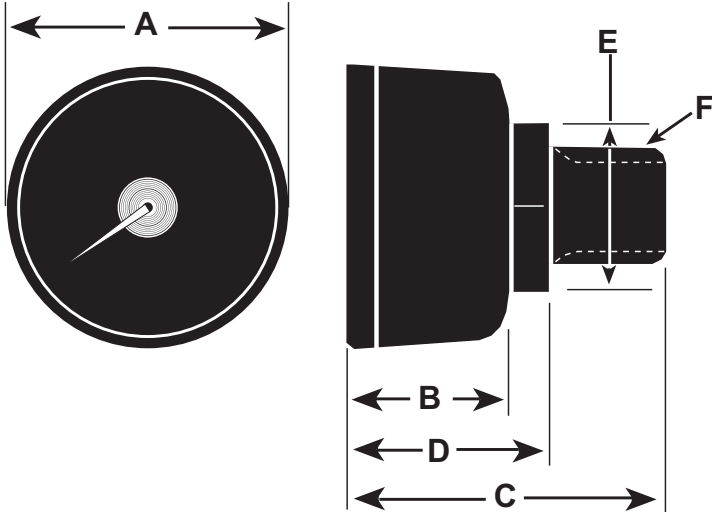

	A	B	C	D	E	F
Inches	0.90	0.55	1.07	0.67	0.56	1/8
(mm)	(23)	(14)	(27)	(17)	(15)	NPT