

- 4½" through 12" dials
- Aluminum case materials
- Dual-scale dials with pressure and temperature indication
- Wide range of refrigerant scales, including refrigerant 134A and ammonia

Ashcroft® refrigeration and ammonia gauges are used to display pressure and temperature when measuring various sealed refrigeration systems. This dual-scale dial gauge has an inner pressure scale with black numerals and an outer temperature scale with red numerals. A selection of models exists to meet specification and price parameters.



Type 1010 Case Style Shown

SPECIFICATIONS

Gauge Type Number	Refrigerant	Dial Size (Inches)	Case & Ring Material	Bourdon Tube, Tip & Socket Material	Tube & Socket Code	Range	Pointer	Movement	NPT Connection
1010A	XR1	R-11	Aluminum, Black Epoxy Coated	Phosphor Bronze Tube, Brass Tip, Brass Socket (all joints silver brazed)	A	30 inH Vac/150 psi or 30 inHg Vac/300 psi	Black Adjustable	Stainless Steel with Teflon coated pinion and segment shaft, rotary geared	1/4 (1/2 optional)
	XR2	R-12							
	XR3	R-22							
	XR4	R-502							
	XR6	R-114							
	XR7	R-500							
	XR8	R-134A							
	XR9	R-123							
	1010S	XR5							

STANDARD METRIC RANGES

RANGE		DIAL GRADUATIONS		RANGE	DIAL GRADUATIONS	
kg/cm ²	bar	Figure Interval	Minor Graduation	kPa (kilopascal)	Figure Interval	Minor Graduation
-1/9	-1/9	1	0.1	-100/900	100	10
-1/24	-1/24	2	0.2	-100/2400	500	20

MOUNTING

Gauge Type Number	Dial Size ⁽¹⁾ (Inches)	Connection Location	Mounting	Method
1010	4½", 6", 8½", 12"	Lower	Stem/Surface	-

STANDARD RANGES

Range	Figure Interval		Minor Graduation	
	Inches Mercury	psi	Inches Mercury	psi
30" Hg Vac/150 psi	10	25	2	5
30" Hg Vac/300 psi	30	25	5	5

TO ORDER THESE REFRIGERATION GAUGES:

- Select: 45 1010 A 02L XR5 30 in. Hg Vac/150#
- Dial size—4½", 6", 8½", 12" _____
 - Case Type—1010 _____
 - Tube and socket material—A, S _____
 - Connection size—¼ (02), ½ (04) _____
 - Connection location—Lower (L), Back (B) _____
 - Optional features including refrigerant (see page 176) _____
 - Standard pressure range—30" Hg Vac/150 psi _____
- Accessories—see pages 233-238

Case Type 1010

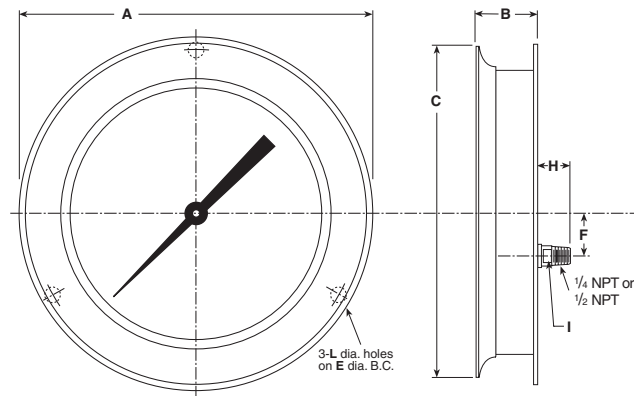
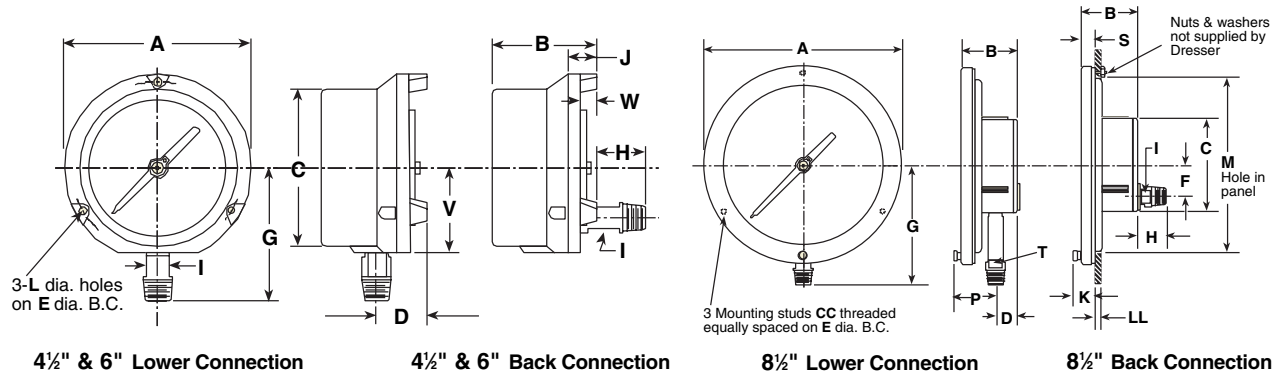

Case Type 1010 4 1/2", 6", 8 1/2" and 12" Back and Lower Connect

Dial Size Inches	A	B	C	D	E	F	G	H	I	J	K	L	M	S	Wgt (lbs)
4 1/2	5 13/16 (148)	3 13/32 (86)	4 7/8 (124)	1 5/8 (41)	5 3/8 (137)	1 5/8 (41)	3 15/16 (100)	7/8 (20)	5/8 (16)	1 1/16 (27)	2 7/8 (60)	.218 (6)	4 15/16 (125)	—	2.5 1.13 kg
6	7 7/8 (194)	2 9/16 (59)	7 (178)	1 5/16 (24)	7 (178)	1 5/8 (41)	5 1/4 (133)	7/8 (20)	5/8 (16)	1 1/16 (27)	3 1/8 (79)	.218 (6)	6 7/16 (164)	—	3.125 1.4 kg
8 1/2	10 1/16 (256)	2 7/8 (73)	4 3/4 (121)	1 11/16 (39)	9 5/8 (244)	1 5/8 (41)	6 (152)	1 3/8 (35)	5/8 (16)	—	1 1/16 (27)	—	9 (228)	1 1/16 (17)	4.5 2.0 kg
12	14 1/2 (368)	2 15/16 (75)	14 1/4 (361)	1 1/2 (26)	13 1/2 (343)	2 1/8 (54)	7 1/2 (191)	1 13/32 (36)	5/8 (16)	3/16 (5)	—	.281 (7)	12 11/16 (329)	3/16 (5)	8 3.6 kg

Drawings are for representation only. See dimension table.