

- 4½" through 12" dials available
- Aluminum case material
- Wide range of types to combine specifics and price
- Slotted link and throttle screw standard

The Ashcroft® line of pressure gauges offers a product that is uniquely designed for rigorous hydraulic services.

Hydraulic gauges are supplied with a slotted link movement to avoid gear wear. All models are supplied with throttle devices as standard.



Type 1010 Case Style



SPECIFICATIONS

Gauge Type Number	Dial Size (Inches)	Connection Location	Mounting	Method
1010-XS4TS	4½", 6", 8½", 12"	Lower/Back	Stem, Surface	-

STANDARD psi RANGES (4)

Range psi	Figure Interval	Minor Graduation
0/1000	100	10
0/1500	200	20
0/2000	200	20
0/3000	500	50
0/5000	1000	50
0/6000	1000	100
0/7500	1000	100
0/10,000	1000	100
0/15,000	2000	200
0/20,000	2000	200

Note: Dual-scale dials showing psi and tons on ram are available on application

BOURDON SUSTEM SELECTION

Dial Size (Inches)	Order Code	Bourdon Tube & Tip Material (1) (all joints TIG welded except "A") (1)	Socket Material	Tube Type	Range Selection Limits (psi)	NPT Conn. (2)
4½", 6" 8½"	A	Phosphor Bronze Tube, Brass Tip, Silver Brazed	Brass	C-Tube	12/1000	1/4
4½", 6" 8½", 12"	S	316 stainless steel	316 stainless steel	C-Tube	12/1500	1/4
4½", 12"	P (3)	K Monel	Monel 400	C-Tube	15/1500	1/4
				Helical	2000/30,000	1/2

(1) For selection of the correct Bourdon system material, see the media application table on page 243 in the OH-1 Ordering Handbook.

(2) Optional connections available, 1/2 NPT where 1/4 NPT is standard, 1/4 NPT where 1/2 NPT is standard.

(3) Use for applications where NACE standard MR-01-75 is specified.

(4) Single-scale and dual-scale ranges available

STANDARD METRIC RANGES(4)

Range		Dial Graduations	
Kg/cm² kilograms per sq. cm.	Bar	Figure Interval	Minor Graduation
0/60	0/60	5	1
0/100	0/100	10	1
0/160	0/160	20	2
0/250	0/250	50	5
0/400	0/400	50	5
0/600	0/600	50	10
0/1000	0/1000	100	10
0/1600	0/1600	200	20

Range	Dial Graduation		Outer Scale with dual range specified psi
kPa (kilopascal)	Figure Interval	Minor Graduation	
0/6000	500	100	0/850
0/10,000	1000	100	0/1400
0/16,000	2000	200	0/2200
0/25,000	5000	500	0.3500
0/40,000	5000	500	0/5500
0/60,000	5000	1000	0/8500
0/100,000	10,000	1000	0/14,000
0/160,000	20,000	2000	0/22,000

HOW TO ORDER THESE HYDRAULIC GAUGES:

Select: _____ 45 _____ 1010 _____ S _____ 02L _____ XS4TS _____ 1000#

- Dial size— 4½", 6", 8½", 12" _____
- Case code: 1010 _____
- Tube and socket material, (see chart above) _____
- Connection size—¼ (02), ½ (04) _____
- Connection location—Lower (L), Back (B) _____
- Options—see page 176 _____
- Standard pressure range—1000 psi _____

Case Type 1010

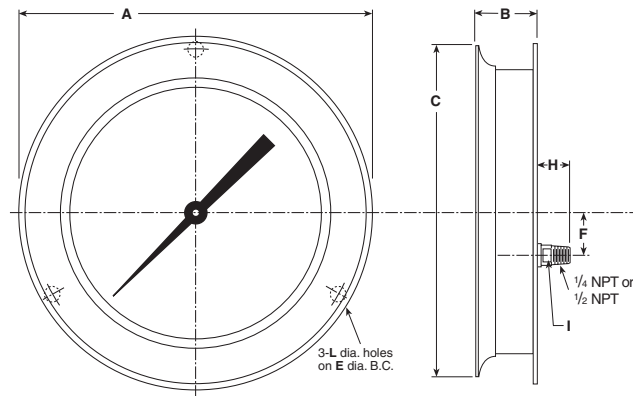
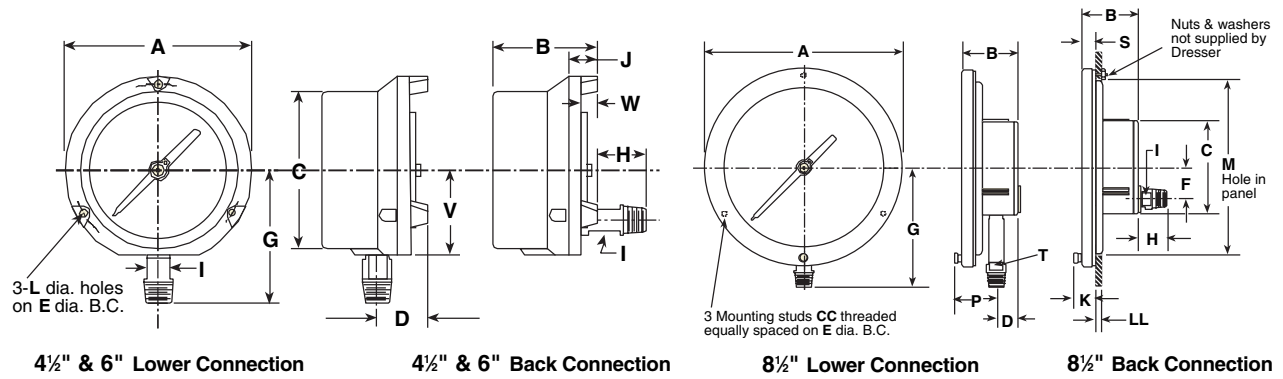

12" Back and Lower Connect

Case Type 1010 4 1/2", 6", 8 1/2" and 12" Back and Lower Connect

Dial Size Inches	A	B	C	D	E	F	G	H	I	J	K	L	M	S	Wgt (lbs)
4 1/2	5 13/16 (148)	3 13/32 (86)	4 7/8 (124)	1 5/8 (41)	5 3/8 (137)	1 5/8 (41)	3 15/16 (100)	7/8 (20)	5/8 (16)	1 1/16 (27)	2 7/8 (60)	.218 (6)	4 15/16 (125)	—	2.5 1.13 kg
6	7 7/8 (194)	2 9/16 (59)	7 (178)	1 9/16 (24)	7 (178)	1 5/8 (41)	5 1/4 (133)	7/8 (20)	5/8 (16)	1 1/16 (27)	3 1/8 (79)	.218 (6)	6 7/16 (164)	—	3.125 1.4 kg
8 1/2	10 1/16 (256)	2 7/8 (73)	4 3/4 (121)	1 11/16 (39)	9 5/8 (244)	1 5/8 (41)	6 (152)	1 3/8 (35)	5/8 (16)	—	1 1/16 (27)	—	9 (228)	1 1/16 (17)	4.5 2.0 kg
12	14 1/2 (368)	2 15/16 (75)	14 1/4 (361)	1 1/2 (26)	13 1/2 (343)	2 1/8 (54)	7 1/2 (191)	1 13/32 (36)	5/8 (16)	3/16 (5)	—	.281 (7)	12 1/16 (329)	3/16 (5)	8 3.6 kg

Drawings are for representation only. See dimension table.