

- 40mm and 50mm sizes
- All-stainless steel construction
- Dry or liquid-filled versions
- Lower or back connect
- Glass window standard
- Front flange or U-clamp available for flush mounting

Ashcroft® 40mm and 50mm all stainless steel pressure gauges help to complete our full-line product offering of stainless steel gauges with dial sizes from 40mm to 100mm. These smaller size gauges are used whenever space limitations and atmospheric and process corrosion exist.



STANDARD RANGES

Pressure Ranges – Single Scale		
psi	kg/cm ²	kPa
0/15	0-1	0-100
0/30	0-2	0-200
0/60	0-2.5	0-250
0/100	0-4	0-400
0/160	0-6	0-600
0/200	0-10	0-1000
0/300	0-16	0-2000
0/400	0-25	0-2500
0/600	0-40	0-4000
0/800	0-60	0-6000
0/1000	0-100	0-10,000
0/1500	0-160	0-20,000
0/2000	0-250	0-25,000
0/3000		
0/5000		

Compound Ranges – Single Scale

psi	kg/cm ²	kPa
30 in.Hg/15 psi	-1/0/1	-100/0/100
30 in.Hg/30 psi	-1/0/3	-100/0/300
30 in.Hg/60 psi	-1/0/5	-100/0/500
30 in.Hg/100 psi	-1/0/9	-100/0/900
30 in.Hg/150 psi	-1/0/15	-100/0/1500
30 in.Hg/300 psi	-1/0/25	-100/0/2500

Vacuum Ranges – Single Scale

psi	kg/cm ²
30/0 in.Hg	-1/0

SPECIFICATIONS

Dial size:	40mm (1½") and 50mm (2")
Accuracy:	ASME B 40.1 Grade B ($\pm 3-2-3\%$ of span)
Optional:	ASME B 40.1 Grade 1A ($\pm 1\%$ of span)
Case:	304 stainless steel with 304 stainless steel polished ring
Bourdon Tube and Socket:	316 stainless steel
Movement:	Stainless steel
Standard connections:	½ NPT standard for 40mm, ¼ NPT standard for 50mm
Dial:	Aluminum, white background with black markings. Pressure range: Vac. through 15,000 psi including compound
Pointer:	Aluminum
Window:	Glass

TO ORDER THIS 1008 PRESSURE GAUGE:

Select: _____ 40 1008 S (L) 01L 1000#

- Dial size—40mm or 50mm _____
- Case type—1008 _____
- Tube and socket material _____
- Liquid filled (glycerin), leave blank if dry _____
- Connection size—½ (01), ¼ (02) _____
- Connection location—Lower (L), Back (B) _____
- Standard pressure range—1000 psi _____

Case Type 1008 – 40mm & 50mm

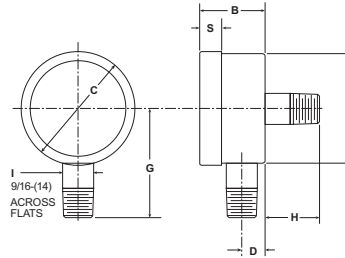

40/50mm lower and back connection

Gauge Size	A	A-1	B	C	C-1	D	DD	DD1	E	FF	G	G-1	H	HH	I	J	L	M	S	Weight	
																				Dry	LF
(40) 1½	(41) 1⅝		(25) 3⅜	(42) 1⅔		(10) ⅜					(43) 1⅜		(20) 25/32		(14) 9/16				(8) 5/16	.08kg .17#	.10kg .22#
(50) 2	(52) 2⅛		(29) 1⅝	(53) 2⅔		(10) ⅜					(48) 1⅞		(24) 15/16		(14) 9/16				(10) 3/8	.12kg .26#	.17kg .37#

Note: Dimensions in brackets () are millimeters.